



Dear ERCS EAGLES!

Welcome! This year will be filled with new ideas, an assortment of learning, powerful adventures and uncharted territory. I think some words for the year will be fluidity, transitional, resilience and compassion.

After our innovative finish to the last school year, we are very excited to get the 2020-2021 school year started. At the typing of this note, we will start in school on August 18th. Since, the unknown is still prevalent with COVID-19, we feel it is not a matter of if we will be exposed but when. Therefore, we will administer a few changes to help mitigate what we can control.

We will always follow mandates. These are not up for our discretion. Please refer to our website for updates or see signage posted on all doors.

We have limited class sizes. We will be keeping shared space at a minimum. We are changing schedules, adding aides, cleaning and downsizing a few areas.

We will be keeping visitors at a minimum in hallways and entryways. This will be a tough one for us as we enjoy face-to-face contact with our parents and guardians. However, this is a safety measure for all. Please be prepared to drop students at entryways and not enter classrooms. If you need to speak with teachers, just let us know, we will step in and make this happen. When on campus, wear masks in common areas and group settings, you are the best example for your children.

We will be requiring masks of staff and students. Students and staff will wear masks, in and out of building, in common areas and when working in close groups. They will not wear them the entirety of the school day. We have been running a small 9-week summer program that has allowed us to implement new ideas and see how students respond. As you know, children are amazing and are great stewards in keeping each other on task and helping take care of each other.

Illness especially fevers and coughs, have taken on a more precautionary approach. All fevers will require, a stay at home policy, fever free without medication for a 72-hour period. Upon return to school, we will be asking for a medical note. We understand normal ear infections, common cold, strep throats, flu etc. will still be happening. Please follow these rules to help keep everyone safe.

If it is confirmed that a student or staff member tests positive for COVID-19, we notify state and municipal health officials as well as every individual who may have been exposed. Further response steps will be dependent on the situation as we follow guidelines and recommendations. We will try to generate as little disruption to classes as possible however, we will also take steps to mitigate safety. We are prepared to go virtual on a case-by-case basis.

As always, please voice, ideas and concerns to us. This is all new for each of us and not one of us is an expert.

I cannot help but hear clearly, Jeremiah 29:11. His hands in ERCS is evident, He will not forsake us. We must use the brains he gave us to do our best to protect and love one another.

In His name we will soar, upwards Eagles!

Michelle Caldwell
Principal

Reaching Others thru Education

EAGLE RIVER CHRISTIAN SCHOOL

BACK-TO-SCHOOL INFORMATION

Dear Parents,

Welcome to another promising year at Eagle River Christian School. We hope your summer went well. **The first day of school is Tuesday, August 18th.**

Our Open House will be held on Monday, August 17th: MASKS REQUIRED!

BUILDING A

Pre-K thru K5 grade **4 to 5 p.m.**

1st thru 3rd grade **5 to 6 p.m.**

BUILDING B

4th thru 8th grade **4 to 5 p.m.**

9th thru 12th grade **5 to 6 p.m.**

This is a time for parents and students to meet the teachers, locate their classroom, pick up schedules and drop off school supplies. We are looking forward to seeing everyone at the Open House.

Serving Christ in Education,
Michelle Caldwell
Principal

START-UP DATES AND TIMES - Please note *DISMISSAL TIMES

KR3 – 12th Grade

Tuesday, August 18th Doors open @ 8:00 a.m.

Classes start promptly @ 8:15 a.m. *Dismissal @ 2:40 p.m. PK3 thru 4th Grade

***Dismissal @ 3:00 p.m. 5th thru 12th Grade**

BEFORE AND AFTER SCHOOL

ELEMENTARY * KR3 – 6th Grade ONLY

Before care * 7:00 a.m. – 8:00 a.m. Building A

After care * 2:40 p.m. – 6:00 p.m. Building B

HOMEWORK CLUB 5th & up (After school)

Mon. through Fri. 3:00 pm to 4:00 pm

Will start September 8th

\$100.00 (Monthly)

\$45.00 (Weekly)

\$15.00 (Daily)

If your 5th or 6th grade child attends the homework club, then @ 4 goes to aftercare, you will be billed the aftercare charge. This is for monthly care.

HEALTH RECORDS

All updated **immunization records** are due before the start of school.

1. **PPD** - **All new students, KR3 through 12th grade, must answer a questionnaire (provided by the school office).** It is **required** by the State of Alaska.
2. All students must have a **physical** on file.
3. A copy of the **student's birth certificate** must be on file.
4. All students participating in any intramural sports must have a **sports physical**.

UNIFORM SHIRTS - REQUIRED

ELEMENTARY AND HIGH SCHOOL

Shirts available August 21st

Polo shirt \$19.00 each

P.E. t- shirt - (**REQUIRED for Middle and High School ONLY**) \$11.00 each

Adult hooded sweatshirt \$28.00

MANDATORY

All students must arrive and leave school with their uniform shirt on.

Our summer office hours are as follows:

July 27th – July 31st office closed

August 12th - 7th 9 a.m. – 1 p.m.

August 10th – 17th 8:30 a.m. – 2:30 p.m.

If any of these times do not work with your schedule, please call 694-4602 and make an appointment. We will be glad to meet with you at your convenience.

MONDAY, SEPTEMBER 7TH * NO SCHOOL * LABOR DAY
THURSDAY & FRIDAY, SEPTEMBER 26TH & 27TH
NO SCHOOL * A.C.S.I. CONFERENCE

Visit our NEW website:

www.eagleriverchristianschool.com

or follow us on Facebook

EagleRiverChristianSchool

Or

PrincipalCaldwell

TRAFFIC PATTERN

PARKING LOT INSTRUCTIONS: Please follow the diagram below for easy and safe drop-off/pick-up.

THIS INCLUDES BEFORECARE AND AFTERCARE

Please drive SLOWLY through all parking lots!!!

Please use the lower parking lot for students KR3 through 2nd grade.

For students in 3rd through 12th grade use the upper parking lot.

MORNING: Doors monitored @ 8:00 a.m. and are locked @ 8:15 a.m.

AFTERNOON: Doors monitored @ 2:35 p.m. and are locked @ 2:45 p.m.

If you are sending a person to pick-up your child/children, they must come to the office first, show a picture I.D. and sign the student out. If you are picking up your child/children early, you must come to the office and sign your child/children out.

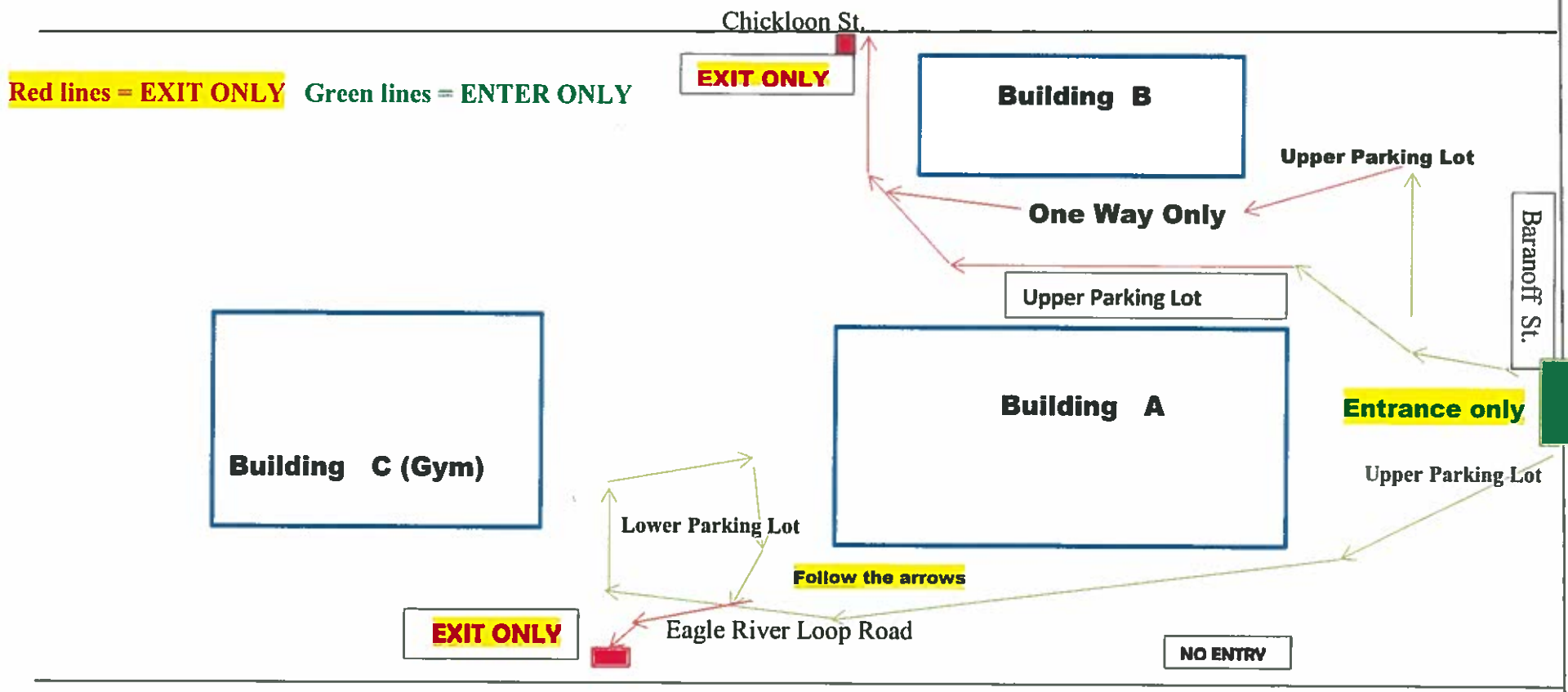

MASKS FOR SALE

\$5.00 EACH

Lots of colors and patterns

There is a pocket to add an extra filter, wire in the nose band

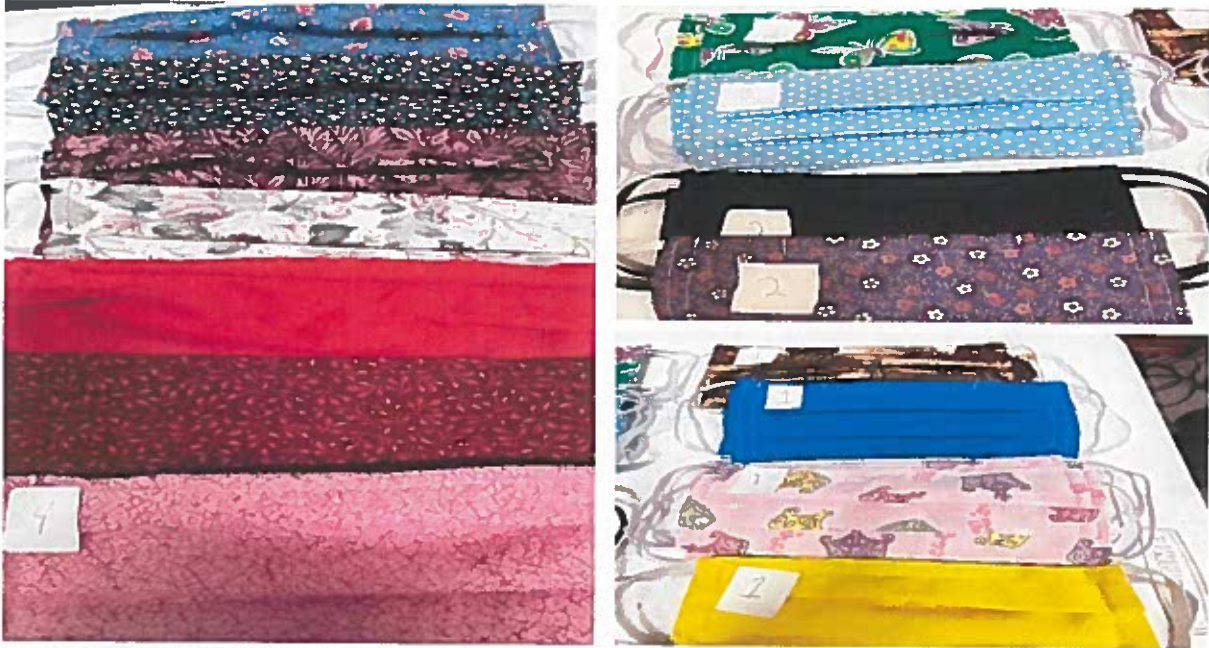

#1 Child size small - 3, 4 and small 5 years old

#2 Child size medium - 5 to 7 years old

#3 Preteen/teen - 3rd grade and up (not shown)

#4 Adult sizes

Available in the school office

EAGLE RIVER CHRISTIAN SCHOOL ACADEMIC CALENDAR 2020-2021

August 2020						
S	M	T	W	T	F	S
						1
2	3	4	5	6	7	8
9	10	11	12	IS	IS	15
16	IS	SO	19	20	21	22
23	24	25	26	27	28	29
30	31					

September 2020						
S	M	T	W	T	F	S
		1	2	3	4	5
6	H	8	9	10	11	12
13	14	15	16	17	18	19
20	21	22	23	IS	IS	26
27	28	29	30			

October 2020						
S	M	T	W	T	F	S
				1	2	3
4	5	6	7	8	9	10
11	12	13	14	15	IS	17
18	19	20	21	C	CC	24
25	26	27	28	29	30	31

November 2020						
S	M	T	W	T	F	S
1	2	NS	4	5	6	7
8	9	10	11	12	13	14
15	16	17	18	19	20	21
22	23	24	25	H	H	28
29	30					

December 2020						
S	M	T	W	T	F	S
		1	2	3	4	5
6	7	8	9	10	11	12
13	14	15	16	17	IS	19
20	V	V	V	V	V	26
27	V	V	V	V		

January 2021						
S	M	T	W	T	F	S
					V	2
3	4	5	6	7	8	9
10	11	12	13	14	15	16
17	H	19	20	21	22	23
24	25	26	27	28	29	30
31						

February 2021						
S	M	T	W	T	F	S
	1	2	3	4	5	6
7	8	9	10	C	CC	13
14	H	16	17	18	19	20
21	22	23	24	25	26	27
28						

March 2021						
S	M	T	W	T	F	S
	1	2	3	4	IS	6
7	V	V	V	V	V	13
14	15	16	17	18	19	20
21	22	23	24	25	26	27
28	29	30	31			

April 2021						
S	M	T	W	T	F	S
				1	H	3
4	5	6	7	8	9	10
11	12	13	14	15	16	17
18	19	20	21	22	23	24
25	26	27	28	29	30	

May 2021						
S	M	T	W	T	F	S
						1
2	3	4	5	6	G	8
9	10	11	12	13	14	15
16	17	18	19	IS	IS	22
23	24	25	26	27	28	29
30	H					

June 2021						
S	M	T	W	T	F	S
		1	2	3	4	5
6	7	8	9	10	11	12
13	14	15	16	17	18	19
20	21	22	23	24	25	26
27	28	29	30			

July 2021						
S	M	T	W	T	F	S
				1	2	3
4	H	6	7	8	9	10
11	12	13	14	15	16	17
18	19	20	21	22	23	24
25	26	27	28	29	30	31

Important Dates to Remember:

Teachers' First Day - August 13
 School Opens - Tuesday, August 18
 ACSI Convention - September 24-25
 1st Quarter Ends - October 16
 2nd Quarter Ends - December 18
 3rd Quarter Ends - March 5
 4th Quarter Ends - May 19
 Last Day of School - **May 19** Release @ 1:15pm
 Summer School Elementary- May 24 - July 23

Calendar Key:

SO - School Opens
V - Vacation (No School)
H - Holiday (No School)
IS - In Service Day (No School) **NS**-No school
C-Parent/Teacher Conf. (1/2 day school Elem. only)
C- P/T Conf. (No School Middle & High School Only)
CC - Parent/Teacher Conf. (No School)
AC- Awards Ceremony 1:30 PM - **May 19**
G - H.S. Graduation - May 7 7:00 pm

Eagle River Christian School
2020 - 2021 School Year

6th Grade Supply List

REQUIRED MASK DAILY

Please label all clothing pieces, pencil box, backpack & lunch box with child's name

- * Bible - New International Version
- * Electronic tablet (does not need to be expensive, but must be able to connect to WiFi).
- * Headphones in a case labeled with student's name.
- * Regular inexpensive calculators
- * 2 Folders with pockets
- * 2 Packs Notebook paper - wide rule
- * 1 - 3 Ring binder (2 inch wide) with pockets
- * 1 - 5 tab dividers
- * 2 Composition notebook
- * 3" x 3" Post-it notes
- * Scissors
- * 12" transparent ruler with inches & cm
- * 2 Dozen #2 pencils
- * 2 Glue sticks
- * 1 Large eraser
- * 1 Pack small erasers (the ones that fit on top of a pencil)
- * 1 Art tablet
- * Colored pencils 12 count
- * Washable markers 10 count
- * 1 Pkg. dry erase markers
- * 2 Black sharpies
- * Small box to keep pencils, scissors, art supplies, etc. (labeled with student's name)
- * 1 Pair of shoes for classroom (for winter)

Mandatory for P.E.:

*1 Pair non-marking tennis shoes (for gym) with a cloth bag

(Not a plastic grocery bag)

*1 Spill proof water bottle - REQUIRED

Items to be shared by 5th grade Class:

- * 2 Large containers of disinfecting wipes
- * 2 Cans of disinfectant spray
- * 2 Bottles of hand sanitizer
- * 2 Boxes of Kleenex tissue
- * 1 Pack white card stock
- * 2 Reams copy paper

This is a mandatory supply list.

**Please send supplies with your student on the first day of school
or during open house.**

Eagle River Christian School
2020 - 2021 School Year

Middle School
7th – 8th Grade Supply List

REQUIRED MASK DAILY

***Bible NIV – Required**

- * 1 Electronic tablet – either Ios or Android or Kindle (Best Buy or Amazon)
- * 12” Ruler with metric
- * 1 Compass
- * 1 Protractor
- * 1 Calculator – NO CELL PHONES ALLOWED
- * Pencils of students choice and erasers (as needed)
- * White out (preferably roll-on)
- * Yellow highlighters
- * Pencil box or pouch
- * Glue Sticks
- * Colored pencils, crayons or markers (at least 8 colors)
- * Scissors
- * 1 Combo lock for the student’s locker
- * Post-it notes
- * 7 Spiral notebooks (one for each subject)
- * 3 Tri-fold boards 1-28” x 40” or larger (for Science); 2-14” x 22” (for History)
- * 3 -1” 3 ring binder – or binders of students choice
- * 3 Folders
- * Student planner
- * 1 Journal (at least 150 pages) /Composition book
- * 1 Dozen #2 pencils with erasers (for testing)
- * 4 Packages of loose leaf paper (2-wide ruled paper/ 2-college ruled paper)

Mandatory for P.E.:

***1 Pair non-marking tennis shoes (for gym) with a cloth bag**
(Not a plastic grocery bag)

Shared items:

- * 2 Reams copy paper
- * 2 Large containers of disinfecting wipes
- * 2 Cans of disinfectant spray
- * 2 Bottles of hand sanitizer
- * 3 Boxes of Kleenex tissue

This is a mandatory supply list.

Please send supplies with your student on the first day of school or during open house.

Additional supplies may be needed during the school year.