

GOODFELLOW INFORMATION PACKET 2016

INDIANA DUNES ENVIRONMENTAL LEARNING CENTER (IDELC)

This packet contains the following information

- 1) Trip Summary / Frequently asked questions / Date reminders
- 2) Letter and program overview from the IDELC
- 3) The "What to bring" list (*please SAVE and follow this list*)
- 4) A sample Frog in the Bog Program Schedule
- 5) Directions to the IDELC

Trip Summary

We leave UCE at 10:00 Wednesday (Your child is expected to be in school at the normal time on Wednesday). Once at the IDELC, there is an orientation of chaperones and students in their trail groups, we move into cabins, have lunch, then go on a "Walk Through Time" during which students meet characters from different time periods of the Dunes Lakeshore history. We return to camp, have dinner, and go on a night hike. Upon return, we have a snack (UCE provided), return to cabins, lights out. Thursday, we have breakfast and go on an all day hike during which we have lunch on the trail and will stop frequently for various activities. We return to camp, have dinner, compile the results of the day, and create skits concerning dilemmas of the National Park. We have a camp fire, return to cabins and lights out. Friday, we pack, have breakfast, perform skits, have a parting ceremony and return to school between 10:30-11:00.

Frequently Asked Questions

Where can I get information about the IDELC program?

Information about the IDELC is on their web site <http://www.duneslearningcenter.org/>. We will be participating in the "Frog in the Bog" program. (Under Programs).

The IDELC requires all participants to fill out the Student Participant form on line.

In order to complete this information, you must go to the web site for the Indiana Dunes Environmental Learning Center:

<http://www.duneslearningcenter.org/>

Click on "Your Visit", then "Documents". Scroll down.

Under Parents, Chaperones, and Students, click on "Student Participant Form". Please complete the form and submit. If you are unable to do so, please contact Ana Brocksmitth at UCE 759-2544.

What are the accommodations at the camp?

The camp itself, located at 700 Howe Road in Chesterton, consists of 10 cabins and a lodge. The cabins are very nice. They each have 4 sets of bunk beds, toilet room, double sink, shower room and plenty of storage. They are heated and air conditioned, each housing 7 students and 1 chaperone (gender specific). We will have meetings and eat meals (with the exception of a lunch on the trail) in the lodge.

Should I bring my child to school the day of departure?

Your child is expected to arrive at school at the normal time the day we leave. It is advisable to bring your child to school the day of departure as they would have much to bring on the bus. Also, please **label** all bags brought to camp with your child's name. It is not advisable to send "new clothes and shoes" that cannot get dirty as we will be outside most of the time, rain, shine, sleet, or snow.

Can I send extra food for my child?

Do not send any extra food to camp with your child. Food is not allowed in the cabin. All of the meals are provided. UCE will take a nut free snack that will be served the 1st night after the night hike.

What if my child has special dietary needs?

If your child has dietary concerns, a form needs to be filled out and either electronically submitted, or may be printed and sent to the Dunes Learning Center. This form can be found online at <http://www.duneslearningcenter.org/documents/> and is located under the "Student Participant Form". Dietary Restrictions include food allergies, diabetes, vegan diet, vegetarian diet or religious requirements. Individuals with food restrictions and special dietary needs should submit a Dietary Restriction Form 3 weeks in advance of arrival. No outside meals may be brought in without this form and Dunes Learning Center approval.

Can my child bring a cell phone or other electronics?

As it states on the "What to bring list", no electronics including cell phones are allowed on the trip. If it is deemed necessary, your child may call you using one of the phones at camp. We will have all of your contact information.

May I come to camp?

Only designated chaperones and UCE staff may accompany us on the trip.

What if my child gets sick while at camp? Who dispenses medication?

We will contact you in the event your child feels ill. If your child must leave, maps and directions to camp are included in this packet (one of which was hand drawn by one of our staff.) The IDELC "Student Participant Form" you fill out will **always** accompany your child with contact and health information. A UCE staff member will dispense medication based on instructions provided by you given to our nurse Mrs. Davis.

Will my child know who will be in their group prior to departure?

We do not tell students who they will be with until they arrive at the IDELC. They will be in cabin/table groups with 6 other students and their chaperone. They will also be divided into trail groups of boys and girls of approx. 15 each with some of our chaperones/staff and a trail group leader from the IDELC. We will notify everyone who the chaperones are prior to the trip.

I am concerned about my child's safety.

It is a **VERY** structured program. The kids are under **constant supervision**. In the event of any emergency we contact the National Park Service 1-800-PARK-TIP (1-800-7275-847) for immediate assistance.

Date reminders

9/09 = Parent Consent for trip / Chaperone request form must be turned in to UCE

9/16 = "Student Participant form" must be submitted on line (IDELC web site)

9/16 = (only if necessary) Dietary Restriction form submitted on line (IDELC web site)

9/16 = Payment due (checks payable to UCE)

9/16 = Union Township Medication consent form due

10/11 = All medications to Mrs. Davis. Please **DO NOT WAIT** until the day we leave.

10/12 to 10/14 = Camp Goodfellow Trip. Please be at UCE between 10:30-11:00 to pick up your child from school on the 14th.

Dear Parent:

Your child is about to embark on an exciting learning adventure that they will never forget. The staff at Dunes Learning Center is eagerly awaiting their arrival, and will do everything possible to make this a positive experience.

Dunes Learning Center's program is interdisciplinary, comprehensive and strengthens both academic and social skills. Your child will actively engage in learning experiences that promote: team building, individual discovery, problem solving, critical thinking, and decision-making skills. The program itself is designed to assist teachers in meeting state and curriculum standards while incorporating traditional outdoor learning activities like campfire songs, games, night hikes and much more.

Dunes Learning Center program staff consists of trained naturalists, each possessing First Aid and CPR certification, as well as training in on-trail emergency management techniques. They are committed to ensuring that your child has a fun learning experience in a safe manner.

You have an important role in preparing your child for this opportunity. Please read the materials in this package carefully. Help your child pack and make sure that they have everything that they are prepared for the weather—and please do not include food or electronic devices. **Complete and submit the required Student Participant Form found online at duneslearningcenter.org/documents as soon as possible. Your child will not be allowed to participate without it.**

In order to totally immerse your child in the program, we ask that you do not phone or ask your child to call home. You are encouraged to "Like" us on Facebook or follow us on Instagram. We do our best to post photos during each program. In the event that an emergency has occurred and you need to reach your child, please use the phone number and address below. If you have any additional questions or concerns, please contact your school staff. If they are unable to address your concerns, feel free to contact Dunes Learning Center staff.

Sincerely,

Dunes Learning Center Program Staff

Dunes Learning Center
700 Howe Road, Porter, IN 46304

(219) 395-9555 during the hours of 9am–5pm
1-800- PARK-TIP (7275-847) during the hours of 5pm–9am

Overview for Parents

Welcome to Dunes Learning Center!

Located in the heart of Indiana Dunes National Lakeshore in northwest Indiana, Dunes Learning Center is approximately 50 miles from downtown Chicago. Our facility opened in 1998, on the grounds of the former U.S. Steel Camp Good Fellow Youth Camp, inside Indiana Dunes National Lakeshore.

Dunes Learning Center is encircled by one of the most scenic trails in the park—The Little Calumet River Trail—providing a 3.5 mile loop around our campus and into the Chellberg Farm and Bailly Homestead historic sites. Woodland wildflowers abound along the river trail and beaver activity can be witnessed while hiking through a mixed hardwood forest. The nearby Cowles Bog Trail, a 4.6-mile loop, winds through some of the most biologically diverse areas of the National Lakeshore—including a section of dunes along the southern edge of Lake Michigan. During their time in the Indiana Dunes, students will visit many different parts of the National Lakeshore and surrounding communities to learn about the history and diversity of the dunes through games, hikes, stewardship projects, tours, and many other exciting activities.

Dunes Learning Center facilities include ten group-style, modern cabins, each accommodating eight people (seven campers with one adult Cabin Leader) and equipped with bunk beds, bathroom facilities, and a private shower. Heating and air-conditioning allow for year-round use.

Cowles Lodge, a large, multi-purpose dining and activity hall, sits at the center of our campus. This facility accommodates groups for dining or other activities. The building is equipped with a certified full-service kitchen, where all meals are prepared by our professional food service staff.

Dunes Learning Center's curriculum is truly interdisciplinary, incorporating the arts, technology, science, math, social studies and language arts. Programs are carefully designed to complement classroom instruction and to meet state and national education standards.

Dunes Learning Center is committed to being a special place for all students. From the moment they step off their school bus to the moment they leave, students become part of a learning community that engages them in fun, hands-on discovery. Every day they have the opportunity to develop their relationship with the environment and become healthier, happier, and smarter in the process.

Dunes Learning Center raises funds for scholarships so that all children have an opportunity to participate. Approximately 25% of the children who attend the residential program receive assistance thanks to area foundations, businesses and individuals donors. For more information about how you can support Dunes Learning Center, call 219-395-9555, or visit our website at www.duneslearningcenter.org.

What to Bring

Frog in the Bog Program is conducted mostly outdoors, so it is necessary to come prepared. If you do not have some of the items **don't buy them**; you may substitute, improvise, or talk to your teacher. **Do prepare for the weather! it can be warm, cold, windy, rainy, sunny, or snowy in the dunes.** Remember that everyone will carry their own luggage. Do not pack more than your student can carry!

- 1 Small Backpack
- 2 Reusable Water Bottles
- 1 Poncho or Raincoat (Winter Coat if Appropriate)
- 1 Hat (Appropriate for Season)
- Warm Gloves, Scarf, Etc. for Cooler Temperatures
- 4-5 Pairs of Warm Socks
- 2 Sweaters or Sweatshirts
- 2-3 Shirts, at least one Long-Sleeved
- 2 Pairs of Long Pants
- Shoes that can get Muddy
- Extra Shoes
- Pajamas
- Lip Protectant (ChapStick, Blistex, etc.)
- Sun Screen
- Bug Spray
- Towel and Washcloth
- Soap, Toothbrush, Toothpaste and other Toiletries
- Comb or Brush
- Sleeping Bag or Rolled-Up Blankets and Pillow
- Extra Plastic Bags for Wet Shoes and Dirty Clothes

OPTIONAL

- Camera
- Binoculars
- Book to read before bed

FOOD AND DRINK ARE NOT ALLOWED IN THE CABINS AT ANY TIME. PLEASE DO NOT BRING FOOD, GUM, CANDY, HAND-HELD ELECTRONICS, CELL PHONES, KNIVES OR WEAPONS OF ANY KIND

Sample Frog in the Bog Program Schedule

Day 1

- 10:30 Arrival, Welcome and Orientation
- 10:45 Dance of the Dunes
- 11:00 Move into Cabins
- 11:15 Weather Helpers Report (Naturalists Only for the first one)
- 11:15 Table Helpers Report
- 11:30 Dining Hall Orientation and Lunch
- 12:45 Trail Group Introductions
- 1:30 Walk Through Time
- 5:00 Break
- 5:15 Table Helpers & Weather Helpers Report
- 5:30 Dinner
- 6:30 Dilemma Introduction
- 7:00 Night Hike
- 9:00 Cabin Time
- 10:00 Quiet Time

Day 2

- 7:45 Table Helpers & Weather Helpers Report
- 8:00 Breakfast
- 8:45 Backwoods Bathroom Talk
- 9:00 Pack Trail Lunches
- 9:15 Board Bus for Travel to Cowles Bog Trailhead
- 9:30 Cowles Bog Hike with Ecosystem Investigations
- 4:30 Return to Dunes Learning Center
- 4:45 Free Time
- 5:15 Table Helpers & Weather Helpers Report
- 5:30 Dinner
- 6:30 Ecosystem Investigation Wrap-Up in Cowles Lodge
- 7:00 Dilemma Skit Prep
- 8:00 Campfire
- 9:00 Cabin Time
- 10:00 Quiet Time

Day 3

- 7:15 Pack up and put luggage on the porch before breakfast
- 7:45 Table Helpers & Weather Helpers Report
- 8:00 Breakfast
- 8:30 Dilemma Skits Presentation, Program Evaluation by Adults
- 9:45 Graduation and Trail Group Letters
- 10:00 Depart

Directions to Dunes Learning Center

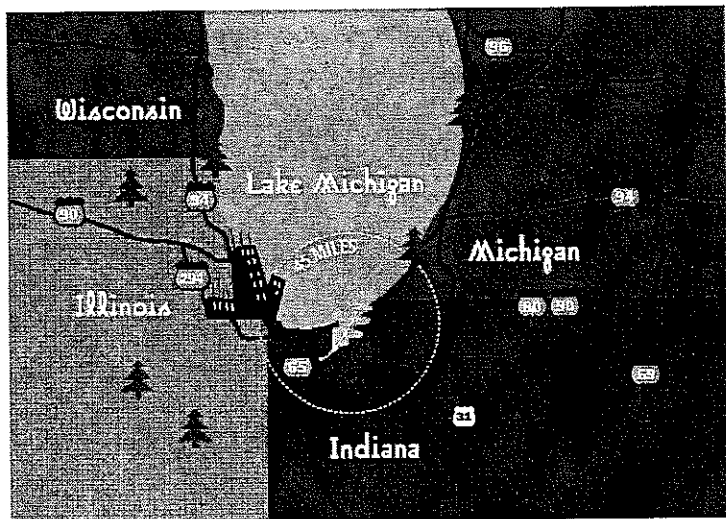

From the West: Take Interstate 94 East to Exit 22B, Porter at U.S. Highway 20 East. Alternatively, take the Indiana Tollway (Chicago Skyway), I-90 East, to Interstate 94 East to Exit 22B, Porter at U.S. Highway 20 East. Once off the interstate, continue east on U.S. Highway 20 for 1.6 miles to Mineral Springs Road (Mineral Springs Road is just past the metal bridge at the second blinking light, opposite the sign for the Spring House Inn). Look for Indiana Dunes National Lakeshore signs directing you to Bailly/Chellberg Farm.

Turn north or left on Mineral Springs Road and continue for 0.4 mile to Oak Hill Road.

Turn left or west on Oak Hill Road and continue 0.4 mile to Howe Road.

Turn left or south on Howe Road. After another 0.2 mile, the Learning Center entrance will be on your right. Enter through the stone gateway and follow the drive past the old Good Fellow Lodge, keeping right at the fork to the camper drop off area before proceeding to the parking area just past Dunes Learning Center's Cowles Lodge.

From the East: Take Interstate 94 West to Exit 22 B, Porter at U.S. Highway 20 East. Alternatively, take the Indiana Tollway, Interstate 80/90 West, to Interstate 94 East to Exit 22B, Porter/U.S. Highway 20 East. Once off the interstate follow the above directions. Mineral Springs Road will be 1.4 miles east on U.S. Highway 20.

From the South: Take Interstate 65 North to Interstate 94 East and follow the above directions from the west.



INDIANA ARTS COMMISSION
MAKING THE ARTS HAPPEN



SOUTH SHORE ARTS



Partner of Indiana Dunes National Lakeshore



Dunes Learning Center

700 Howe Road

Porter, IN 46304

Phone: (219) 395-9555

Fax: (219) 395-8160

info@duneslearningcenter.org

www.duneslearningcenter.org



National Endowment for the Arts
1965

ART WORKS.

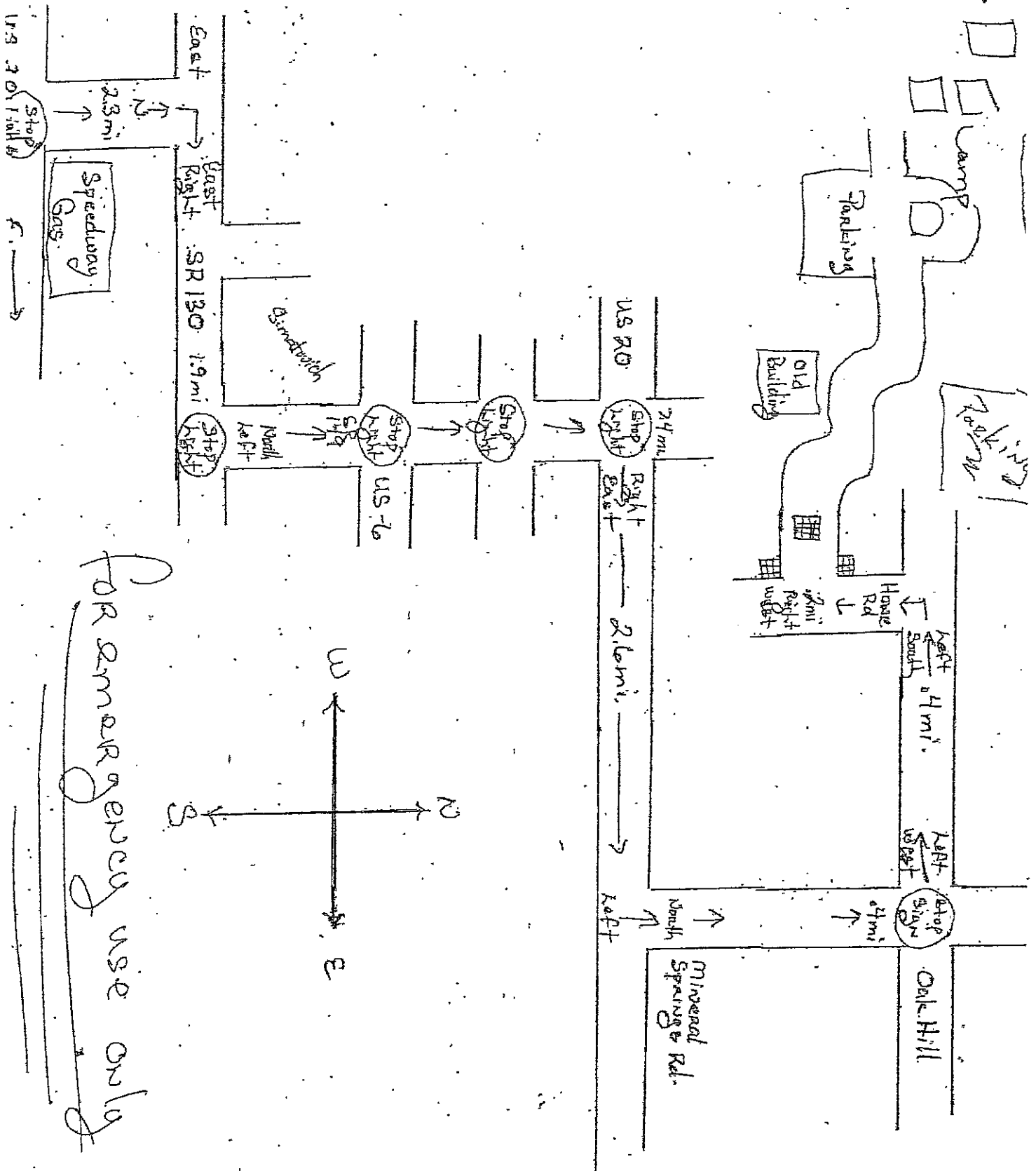

For emergency use only