

CAFETERIA SIZE
CALCULATION

Student Population: 1,000 Students
Current Lunch Periods: 9

Grades: K, 1, 2, 3, 4, 5, 6, 7, 8, 9, 10, 11, 12 (13 grades)

Assumed population for each grade is the same.
 $1,000 / 13 = 77$ Students per grade.

Existing SF: 2,700 sf
SF/Occupant 20 sf/student

Scenario – 5 Lunch Periods
K/1/2, 3/4/5, 6/7/8, HS, HS
Each lunch (max) 231 students

Required SF: 4,620 sf
Addition Required: 1,920 sf

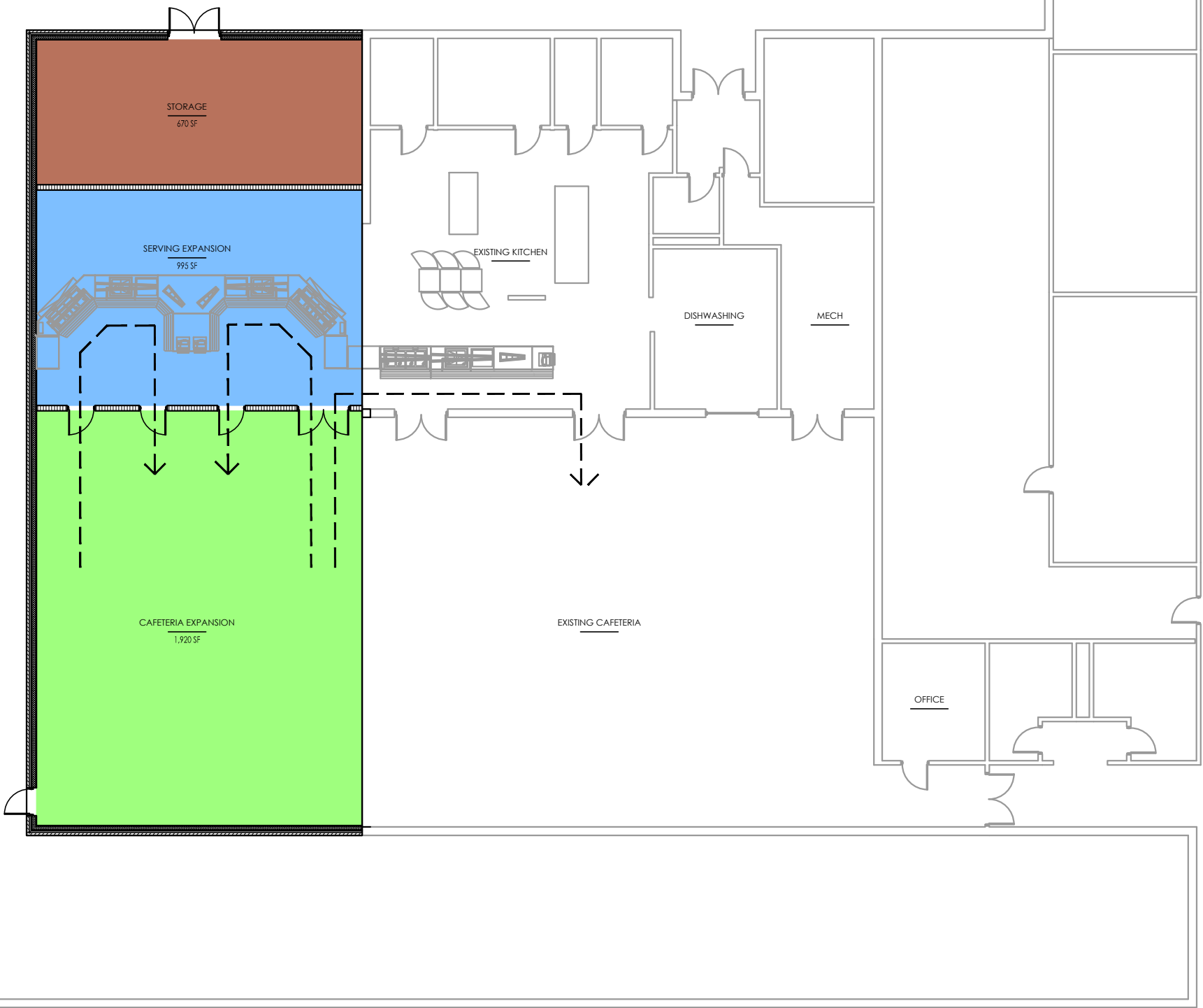

SCALE: 3/32" = 1'-0"