

EXECUTIVE SUMMARIES

During the course of the inspection at the New Milford High School, three (3) material types were sampled and analyzed for asbestos content. These samples represented materials that were previously assumed to be ACM and were sampled to determine the actual asbestos content of the material.

The following materials were sampled and analyzed for asbestos content:

<u>Material</u>	<u>Location</u>	<u>Status</u>	<u>Result</u>
1. Elbow mud pack fittings	1970 addition	previously assumed	Negative
2. 9"x9" floor tile	1962, 1970, & 1986 <i>black in hallway is damaged minor & tiles missing</i>	previously assumed	3% Chrysotile
3. 12"x12" floor tile	1970 addition <i>CR-904/6 beige good</i>	previously assumed	2% Chrysotile

No additional ACM was identified.

During the course of the three-year reinspection, a total of three (3) areas were assessed differently from the original inspection. These areas represented areas where the condition of the ACM had changed or deteriorated. These areas include the following locations:

1. Classroom 153 Transite fume hood.
2. Throughout 9" x 9" floor tile.
3. 1970 addition Elbow mud pack insulation.

The fume hood in Classroom 153 is newly identified and should be placed in the O & M Program. The only change in the 9" x 9" floor tile is that some areas have been covered with new tile or carpeting. The 1970 addition elbows were found to be negative for asbestos and will be removed from the O & M Program.

The only area of removal is the pipe insulation under the auditorium stage, this material was identified as requiring abatement in the original plan.

A tentative start and completion date is also included in the last column of the Reinspection Form 2. The cost associated with the abatement of the ACM noted as being damaged or significantly damaged is given in the following cost estimates. These line items are also prioritized.

ABATEMENT COST ESTIMATES

<u>Location</u>	<u>Response Action</u>	<u>ACBM Qty</u>	<u>Estimated Contractor Cost</u>
1. Auditorium stage	4	20 LF	\$750

It should be noted that only locations with assessments of 1 through 5 are recommended for abatement.

Consulting Fees

It is estimated that approximately \$500.00 will be required for project monitoring during removal. An additional consulting fee of approximately \$250.00 is estimated for AHERA required project design, associated contract administration and project management.

EPA CERTIFICATION REQUIREMENTS

The certificates of the individuals involved in conducting the inspections and preparing the management plan update are appended to this document.

School New Milford High Building 1962 with 1970 + 1986 Adds. Date(s) of Original AHERA Inspection March 1-6, 90

Homogeneous sampling areas		Material category	Asbestos content	Friability	AHERA assessment category (1-7, X, None)	Recorded locations of material for each assessment category	Response actions taken/renovations/other comments
ID number	Material description						
A(1)	Boiler, plumbing and flue breaching	(TSI) Surf. Misc.	Assumed Yes (No)	F NF X	None	Boiler Room	Non-ACBM
A(2)	Asbestos containing Cement fittings on FG Lines 440	(TSI) Surf. Misc.	Assumed Yes No	F NF X	7	1962 Section Pipe Tunnels + Vertical Risers to 1st + 2nd floors	Sampled on 2-8-93 Non-ACBM
A(2)	Asbestos containing aircell 20LF	(TSI) Surf. Misc.	Assumed Yes No	F NF X	1	Under auditorium stage	✓ Same.
A(2)	Asbestos containing cement fittings on FG Lines 2	(TSI) Surf. Misc.	Assumed Yes No	F NF X	1	West tunnel entrance	✓
A(2)	" 1	(TSI) Surf. Misc.	Assumed Yes No	F NF X	1	90' into west tunnel	✓
A(2)	" 1	(TSI) Surf. Misc.	Assumed Yes No	F NF X	1	Pump pit under stage	7

Information abstracted by Haine Vlasoff Date 5/28/93

Friability: F = friable, NF = nonfriable, X = not applicable (material is non-ACBM)
 AHERA assessment category: 1 = Damaged or significantly damaged TSI ACBM, 2 = Damaged friable surfacing ACBM, 3 = Significantly damaged friable surfacing ACBM, 4 = Damaged or significantly damaged friable miscellaneous ACBM, 5 = ACBM with potential for damage, 6 = ACBM with potential for significant damage, 7 = Any remaining friable ACBM or friable suspected ACBM, X = not applicable (material is non-ACBM or nonfriable surfacing or miscellaneous material), None = No assessment category provided in original inspection.

School New Milford High Building 182 with 1970 + 1986 Adds Date(s) of Original AHERA Inspection March 1-6, 90

Homogeneous sampling areas		Material category	Asbestos content	Friability	AHERA assessment category (1-7, X, None)	Recorded locations of material for each assessment category	Response actions taken/renovations/other comments
ID number	Material description						
A(2)	Asbestos containing cement fittings on FG Lines	(TSI) Surf. Misc.	(Assumed) Yes No	(F) NF X	1	Below Room 113	Sampled on 2-8-93 Non-ACBM
A(2)	" "	(TSI) Surf. Misc.	(Assumed) Yes No	(F) NF X	1	Below Student Store	
A(2)	" "	(TSI) Surf. Misc.	(Assumed) Yes No	(F) NF X	1	Below Room 119	
A(2)	Asbestos containing floor debris	(TSI) Surf. Misc.	(Assumed) Yes No	(F) NF X	1	West tunnel entrance	
A(2)	" " 10 SF	(TSI) Surf. Misc.	(Assumed) Yes No	(F) NF X	1	40' into west tunnel	
A(2)	" " 20 LF	(TSI) Surf. Misc.	(Assumed) Yes No	(F) NF X	1	Pump pit under stage	

Information abstracted by Alaine V. Lagasse Date May 28, 93

Friability: F = friable, NF = nonfriable, X = not applicable (material is non-ACBM)
 AHERA assessment category: 1 = Damaged or significantly damaged TSI ACBM, 2 = Damaged friable surfacing ACBM, 3 = Significantly damaged friable surfacing ACBM, 4 = Damaged or significantly damaged friable miscellaneous ACBM, 5 = ACBM with potential for damage, 6 = ACBM with potential for significant damage, 7 = Any remaining friable ACBM or friable suspected ACBM, X = not applicable (material is non-ACBM or nonfriable surfacing or miscellaneous material), None = No assessment category provided in original inspection.

School New Milford High

Building 1982 with 1970 + 1986 Addts.

Date(s) of Original AHERA Inspection March 1-6, 90

Homogeneous sampling areas		Material category	Asbestos content	Friability	AHERA assessment category (1-7, X, None)	Recorded locations of material for each assessment category	Response actions taken/renovations/other comments
ID number	Material description						
A(2)	Asbestos containing floor debris 15F	(TSI) Surf. Misc.	Assumed Yes No	(F) NF X	1	Below Room 113	Sampled on 2-8-93 Non-ACBM
A(2)	" 35F	(TSI) Surf. Misc.	Assumed Yes No	(F) NF X	1	Below Room 125	
A(3)	Asbestos containing fittings on FG lines A/Dc (Above Drop ceiling)	(TSI) Surf. Misc.	Assumed Yes No	(F) NF X	7(7)	1970 Section Outside of room 143 (10) P.F. Fittings	
A(3)	" 82 fittings	(TSI) Surf. Misc.	Assumed Yes No	(F) NF X	7	Throughout the 1970 addition	outside classroom 155 (2)
A(4)	" 126 fittings	(TSI) Surf. Misc.	Assumed Yes No	(F) NF X	7	1970 Section Pipe Funnels	
B(1)	Cementitious wall and ceiling plaster 9,732 SF	TSI (Surf) Misc.	Assumed Yes No	F NF X	None	Classroom walls, hallway walls, in the stairwells and service areas	Non-ACBM

Information abstracted by Alahe Vlagose Date May 28, 93

Friability: F = friable, NF = nonfriable, X = not applicable (material is non-ACBM)

AHERA assessment category: 1 = Damaged or significantly damaged TSI ACBM, 2 = Damaged friable surfacing ACBM, 3 = Significantly damaged friable surfacing ACBM, 4 = Damaged or significantly damaged friable miscellaneous ACBM, 5 = ACBM with potential for damage, 6 = ACBM with potential for significant damage, 7 = Any remaining friable ACBM or friable suspected ACBM, X = not applicable (material is non-ACBM or nonfriable surfacing or miscellaneous material), None = No assessment category provided in original inspection.

Sample Reinspection Form 1. Original AHERA Inspection Information Abstracted from the Management Plan

School New Milford High

Building 1962 with 1970+1986 Additions

Date(s) of Original AHERA Inspection March 1-6, 90

Homogeneous sampling areas		Material category	Asbestos content	Friability	AHERA assessment category (1-7, X, None)	Recorded locations of material for each assessment category	Response actions taken/renovations/other comments
ID number	Material description						
B(2)	Cementitious wall plaster 1,350 SF	TSI Surf. Misc.	Assumed Yes No	F NF X	None	1970 Section classrooms walls and in hallways	Non-ACBM
C(1)	2'x4' lay-in ceiling Tile 39,155 SF	TSI Surf. Misc.	Assumed Yes No	F NF X	None	Throughout the 1970 Section	Non-ACBM
C(2)	1'x1' perforated cellulose-type ceiling tiles 28,767 SF	TSI Surf. Misc.	Assumed Yes No	F NF X	None	1962 section	Non-ACBM
C(3)	2'x4' lay-in ceiling Tile 2,056 SF	TSI Surf. Misc.	Assumed Yes No	F NF X	None	1962 section	Non-ACBM
C(4)	Transite paneling Lab hood	TSI Surf. Misc.	Assumed Yes No	F NF X	X	Room 148	
C(5)	Vinyl-asbestos floor Tile 9'x9'+1'x1' 67,245 SF	TSI Surf. Misc.	Assumed Yes No	F NF X	X	Throughout the school	71

Information abstracted by Ahane Ugase Date May 28, 93

Friability: F = friable, NF = nonfriable, X = not applicable (material is non-ACBM)

AHERA assessment category: 1 = Damaged or significantly damaged TSI ACBM, 2 = Damaged friable surfacing ACBM, 3 = Significantly damaged friable surfacing ACBM, 4 = Damaged or significantly damaged friable miscellaneous ACBM, 5 = ACBM with potential for damage, 6 = ACBM with potential for significant damage, 7 = Any remaining friable ACBM or friable suspected ACBM, X = not applicable (material is non-ACBM or nonfriable surfacing or miscellaneous material), None = No assessment category provided in original inspection.

Sample Reinspection Form 2. Reinspection of ACBM: Findings and Management Planner Recommendations

School New Milford High School Building 1962 wing Date(s) of Reinspection June 16, 1993

Homogeneous Sampling Area: Material Description Air Cell Pipe Insulation ID Number A(2)

REINSPECTION FINDINGS FOR ACBM					MANAGEMENT PLANNER RECOMMENDATIONS		
Location(s) of ACBM by assessment category	Quantity	Friability	Assessment category (1-7, X)	Justification of assessment category	Change in assessment	Preventive measures, response actions, and initial/additional cleanings	Schedule
					Yes		Begin
					No		Complete
Under Auditorium Stage Area.	20 LF.	<input checked="" type="radio"/> F	1	Material is damaged and some material is on floor surface below.	Yes	4	8-94
Under Auditorium Stage Area.	20 LF.	<input checked="" type="radio"/> F	1	Material is damaged and some material is on floor surface below.	Yes	4	8-94
Under Auditorium Stage Area.	20 LF.	<input checked="" type="radio"/> F	1	Material is damaged and some material is on floor surface below.	Yes	4	8-94

Were additional samples of this ACBM collected? Yes No

Date of management planner review: 7-6-93

Inspector name Bob Meccer

Management planner name RAYMOND R. FOLINO

Inspector signature [Signature]

Management planner signature [Signature]

Accreditation #/State 93-846-136-108 / CT

Expiration date 6-14-94

I, the LEA's Designated Person, have read and understood the recommendations made above. Date: _____

Sample Reinspection Form 2. Reinspection of ACBM: Findings and Management Planner Recommendations

School New Milford High School Building 1970 Addition Date(s) of Reinspection June 16, 1993
 Homogeneous Sampling Area: Material Description Mud-Block Ceiling on Fig. Lines ID Number A(3)

REINSPECTION FINDINGS FOR ACBM					MANAGEMENT PLANNER RECOMMENDATIONS		
Location(s) of ACBM by assessment category	Quantity	Friability	Assessment category (1-7, X)	Justification of assessment category	Change in assessment	Preventive measures, response actions, and initial/additional cleanings	Schedule
					Yes <input type="checkbox"/> No <input checked="" type="checkbox"/>		Begin
Throughout wing above drop Ceiling, 1st floor	186	<input checked="" type="checkbox"/> NF	7	Material is in good condition and has limited accessibility	Yes <input type="checkbox"/> No <input checked="" type="checkbox"/>	Non ACBM	
Throughout old and new wing Sinks in Science classrooms Some Sinks were inaccessible locked.	300 estimated	<input checked="" type="checkbox"/> NF	7	Condition of Material in most cases is Unknown. (Newly Identified).	Yes <input checked="" type="checkbox"/> No <input type="checkbox"/>	Non ACBM	
Room 140 Hall adj to 222 Science Prep Room under Counter	4 2 24	<input checked="" type="checkbox"/> NF	1	Material is damaged with some debris on ceiling tiles or bottom of cabinet.	Yes <input checked="" type="checkbox"/> No <input type="checkbox"/>	Non ACBM	

Were additional samples of this ACBM collected? Yes No Negative for Asbestos.

Inspector name Bob Mercier
 Inspector signature _____
 Accreditation #/State _____
 Expiration date _____

Date of management planner review: _____

Management planner name RAYMOND R. FOLINO
 Management planner signature [Signature]
 Accreditation #/State _____
 Expiration date _____

I, the LEA's Designated Person, have read and understood the recommendations made above: _____ Date: _____

Sample Reinspection Form 2. Reinspection of ACBM: Findings and Management Planner Recommendations

School New Milford High School Building 1970 addition Date(s) of Reinspection June 16, 1993

Homogeneous Sampling Area: Material Description Mud-Block fillings on F.G. Lines. ID Number A(4-)

REINSPECTION FINDINGS FOR ACBM					MANAGEMENT PLANNER RECOMMENDATIONS			
Location(s) of ACBM by assessment category	Quantity	Friability	Assessment category (1-7, X)	Justification of assessment category	Change in assessment	Preventive measures, response actions, and initial/additional cleanings	Schedule	
							Begin	Complete
1970 pipe tunnel Side A - See drawing	90 fillings	<input checked="" type="radio"/> F	7	Material is in good condition	Yes	Non ACBM		
1970 P.P. tunnel Side B - See drawing	620 fillings	NF			<input checked="" type="radio"/> No			
Maintenance Garage	130 fillings							
1970 Pipe Tunnel Side A.	6 fillings	<input checked="" type="radio"/> F	1	Material is damaged with debris on floor surface.	<input checked="" type="radio"/> Yes	Non ACBM		
1970 pipe tunnel Side B	10 fillings	NF			No			
Maintenance Garage	1 filling							
		F			Yes	Non ACBM		
		NF			No			
Were additional samples of this ACBM collected? <input checked="" type="radio"/> Yes <input type="radio"/> No					Date of management planner review: _____			
Inspector name <u>Bob Mercier</u>					Management planner name <u>RAYMOND R. FOLINO</u>			
Inspector signature _____					Management planner signature 			
Accreditation #/State _____					Accreditation #/State _____			
Expiration date _____					Expiration date _____			

I, the LEA's Designated Person, have read and understood the recommendations made above: _____ Date: _____

Sample Reinspection Form 2. Reinspection of ACBM: Findings and Management Planner Recommendations

School New Milford High School Building 1970 Wing Date(s) of Reinspection June 16, 1993
 Homogeneous Sampling Area: Material Description Transite Lab Hood ID Number C(4)

REINSPECTION FINDINGS FOR ACBM				MANAGEMENT PLANNER RECOMMENDATIONS			
Location(s) of ACBM by assessment category	Quantity	Fria- bility	Asses- ment cate- gory (1-7, X)	Justification of assessment category	Change in assess- ment	Schedule	
						Preventive measures, response actions, and initial/additional cleanings	Begin
Room 148	30 SF.	F	X	Material is in good condition.	Yes	7	
Room 153 (Newly identified)	30 SF.	F	X	Newly identified Material is in good condition.	Yes	7	
		F			Yes		
		NF			No		

Were additional samples of this ACBM collected? Yes No

Date of management planner review: _____

Management planner name: **RAYMOND R. FOLINO**

Management planner signature: 

Accreditation #/State: _____

Expiration date: _____

I, the LEA's Designated Person, have read and understood the recommendations made above: _____ Date: _____

Sample Reinspection Form 2. Reinspection of ACBM: Findings and Management Planner Recommendations

School New Milford High School Building 1962 with 1970 + 1986 additions Date(s) of Reinspection June 16, 1993

Homogeneous Sampling Area: Material Description 9" x 9" Floor Tile ID Number C(5)

REINSPECTION FINDINGS FOR ACBM					MANAGEMENT PLANNER RECOMMENDATIONS		
Location(s) of ACBM by assessment category	Quantity	Friability	Assessment category (1-7, X)	Justification of assessment category	Change in assessment	Preventive measures, response actions, and initial/additional cleanings	Schedule
					Yes		Begin
					No		Complete
See Floor Plan for locations of 9x9 tile. Entry way damaged. Some minor damage.	± 30,000	F (NF)	X	Material is in good condition.	Yes (No)	7	
See floor plan for location of 9x9 tile covered with tile or carpeting. Some minor damage.	± 15,000	F (NF)	X	Material has been covered with new 12x12 vector carpet.	Yes (No)	7	
Were additional samples of this ACBM collected?	Yes (No)	F (NF)			Yes (No)		
Inspector name <u>Bob Marrier</u>					Date of management planner review: <u>RAYMOND R. FOLINO</u>		
Inspector signature _____					Management planner name <u>Raymond R. Folino</u>		
Accreditation #/State _____					Management planner signature <u>[Signature]</u>		
Expiration date _____					Accreditation #/State _____		
					Expiration date _____		

I, the LEA's Designated Person, have read and understood the recommendations made above: _____ Date: _____

Sample Reinspection Form 2. Reinspection of ACBM: Findings and Management Planner Recommendations

School New Milford High School Building 1962 with 1970 and 1980m additions Date(s) of Reinspection June 16, 1993

Homogeneous Sampling Area: Material Description 12" x 12" Floor tile ID Number C(5)

REINSPECTION FINDINGS FOR ACBM					MANAGEMENT PLANNER RECOMMENDATIONS		
Location(s) of ACBM by assessment category	Quantity	Fraility	Assessment category (1-7, X)	Justification of assessment category	Change in assessment	Preventive measures, response actions, and initial/additional cleanings	Schedule
					Yes		Begin
					No		Complete
See plan for location of original 12" x 12" floor tile	22,000 SF	F	X	Material is in good condition	Yes	7	
		NF			No		
		F			Yes		
		NF			No		

Were additional samples of this ACBM collected? Yes No Positive (2% Chrysotile)

Date of management planner review: _____

Inspector name Bob Mercier Management planner name RAYMOND R. FOLINO

Inspector signature _____ Management planner signature _____

Accreditation #/State _____ Accreditation #/State _____

Expiration date _____ Expiration date _____

I, the LEA's Designated Person, have read and understood the recommendations made above: _____ Date: _____

PLEASE POST

NEW MILFORD HIGH SCHOOL
FIRST FLOOR

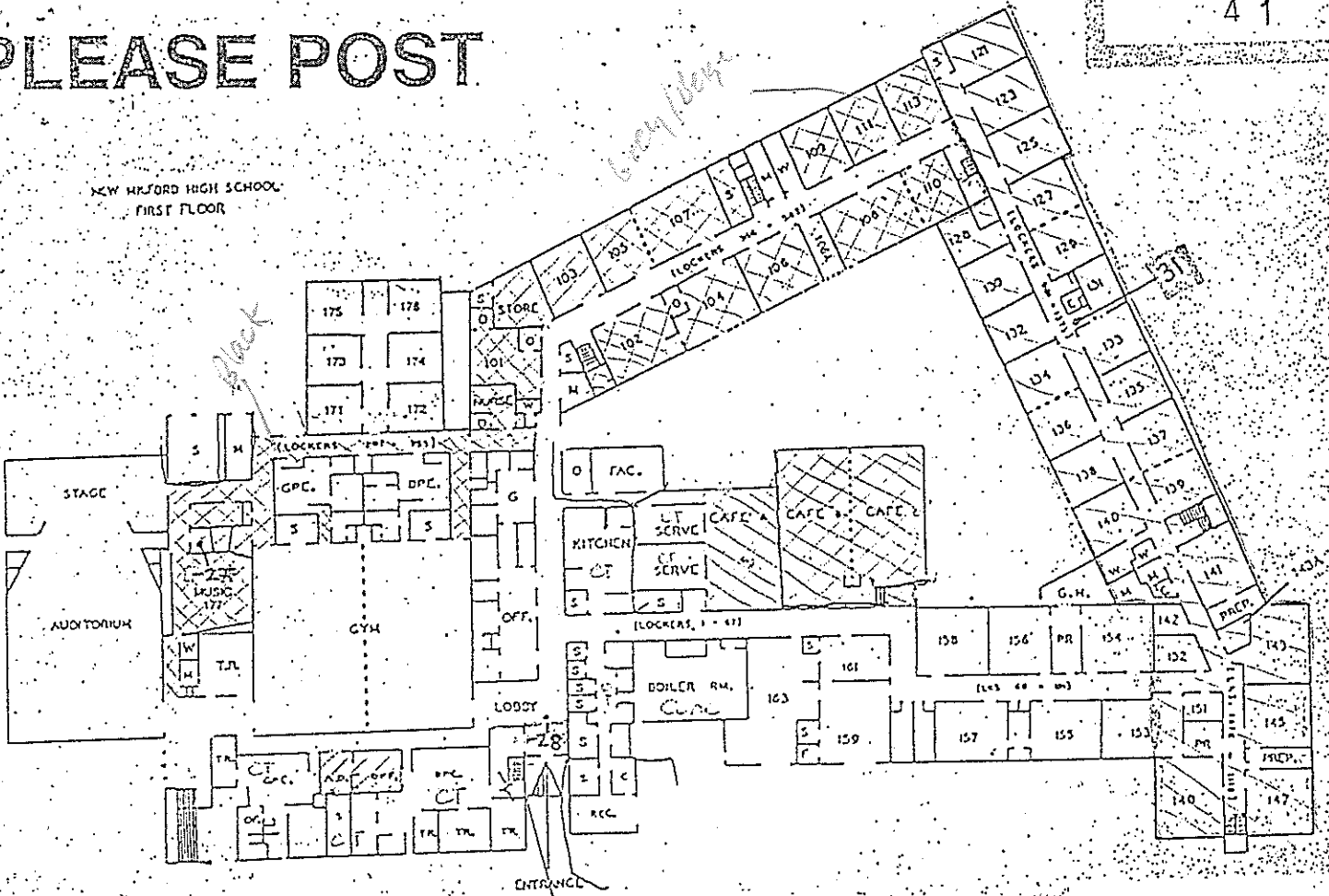

SAMPLE LOCATIONS
2-22-90PB-XX

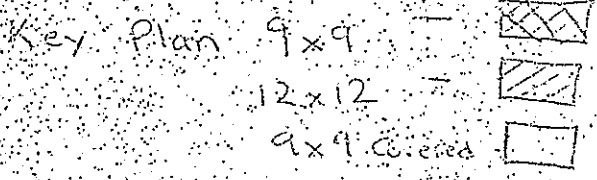

NEW MILFORD HIGH SCHOOL
SECOND FLOOR

