



**Newberry County Schools
Stimulus Grant HVAC Project
Mid Carolina Middle School
Bids: November 2010**



Mr. Bennie Bennett
District Superintendent

SPECIFICATIONS:

LICENSED HVAC CONTRACTORS ARE INVITED TO BID THE INSTALLATION OF EIGHT (8) 2-1/2 TON BARD WALL MOUNTED HEAT PUMPS SUPPLIED BY NEWBERRY COUNTY SCHOOLS. THE UNITS WILL BE PROVIDED BY THE DISTRICT AND THE CONTRACTOR IS TO PROVIDE THE FOLLOWING IN THE INSTALLATION:

- A. ALL MATERIALS AND LABOR REQUIRED TO INSTALL THE EIGHT BARD UNITS. THIS WILL INCLUDE THE DEMOLITION OF THE EXISTING WALLS, ROUGH IN OF THE PROPER SUPPLY AND RETURN GRILLE DUCT OPENINGS, AND INSTALLATION OF THE GRILLES.**
- B. ELECTRICAL WORK ASSOCIATED WITH THE INSTALLATION OF THE BARD UNITS. ALL POWER AND CONTROL WIRING WILL BE RUN IN CONDUITS (NOT EMT) AND ALL WIRING AND CONDUITS WILL BE REQUIRED TO MEET THE STANDARDS OF THE NATIONAL ELECTRICAL CODE.**
- C. CONTROL WIRING AND INSTALLATION OF THE TSTAT SUPPLIED WITH THE UNITS.**

BID DATE: SEALED BIDS WILL BE RECEIVED ON NOVEMBER 17TH, 2010 AT 2PM IN THE MID CAROLINA MIDDLE SCHOOL MULTIPURPOSE ROOM AT 6794 US HIGHWAY 76 IN PROSPERITY. THE DISTRICT PHONE NUMBER IS 803-321-2600.

PREBID CONFERENCE: A MANDATORY PREBID CONFERENCE WILL BE HELD AT 4PM ON 11/5/10 AT MID CAROLINA MIDDLE SCHOOL MULTIPURPOSE ROOM.

JOBSITE LOCATION: THE JOBSITE IS LOCATED AT 6794 US HIGHWAY 76 ADJACENT TO THE NEW MID CAROLINA HIGH SCHOOL. THE CAMPUS CONTAINS THE ORIGINAL MID CAROLINA MIDDLE SCHOOL AND THE OLD MID CAROLINA HIGH SCHOOL BUILDINGS.

QUESTIONS: QUESTIONS ON THIS PROJECT MAY BE ADDRESSED TO:

**MR. KENNETH RAWLS, ENERGY MANAGER & CAPITAL PROJECTS COORIDINATOR
NEWBERRY COUNTY SCHOOLS
1539 MARTIN STREET
NEWBERRY, SOUTH CAROLINA 29108
PHONE: 803-321-2600**

PROJECT START DATE: NOVEMBER 18, 2010
PROJECT COMPLETION DATE: DECEMBER 29, 2010

WORK SCHEDULE: WORK CAN BE DONE ROUGHING IN THE WALL WORK ON THE EXTERIOR OF THE BUILDINGS BEGINNING ON NOVEMBER 18TH, 2010 OR SOON AFTER. ALL WALL WORK, ROUGH IN OF UNITS, ETC IS EXPECTED TO BE COMPLETED BEFORE THE BEGINNING OF THE CHRISTMAS HOLIDAYS. ALL UNITS WILL BE MOUNTED DURING THE CHRISTMAS HOLIDAYS ALONG WITH THE ELECTRICAL WORK BEING COMPLETED.

WORKMEN MUST WORK AFTER FOUR PM ON SCHOOL DAYS ON THE EXTERIOR OF THE BUILDING AND WORK MUST BE COMPLETED EACH DAY BY 11PM. DURING CHRISTMAS HOLIDAYS OR ON WEEKENDS WORK MAY BE ACCOMPLISHED AT ANY TIME.

NOTES:

1. THERE WILL BE 8 TWO AND ONE HALF TON BARD UNITS INSTALLED IN THE 8 LOCATIONS OF THE OLD HIGH SCHOOL BLDG. WHERE SHOWN.
2. THERE ARE TWO DIFFERENT KINDS OF WALLS WHERE THE UNITS ARE TWO BE INSTALLED. ONE SHOWN AS UNIT FOUR HAS A CONCRETE BLOCK WALL. ALL 7 OTHERS WILL BE INSTALLED OVER A STUCCO WALL WITH 4 INCH STUDS.

5. IN ALL OTHER UNITS, INSTALL THE HEAT PUMP BETWEEN THE WINDOWS. AT UNIT ONE, REMOVE THE BUSHES IN FRONT OF THE UNIT TO ALLOW 18 INCHES OF CLEARANCE ON EITHER SIDE OF THE UNIT.
6. ON ROOM 4 (CONCRETE BLOCK) MOUNT A FOUR BY EIGHT SHEET OF EXTERIOR GRADE PLYWOOD ON THE EXTERIOR OF THE BUILDING AFTER THE HOLE IS SAW CUT. COVER THE SHEET OF PLYWOOD WITH A WHITE SHEET OF 22 GA ALUMINUM. DO THE SAME ON THE INSIDE OF THE BUILDING WITH THE PLYWOOD COVERING THE SUPPLY AND RETURN GRILLE OPENINGS.

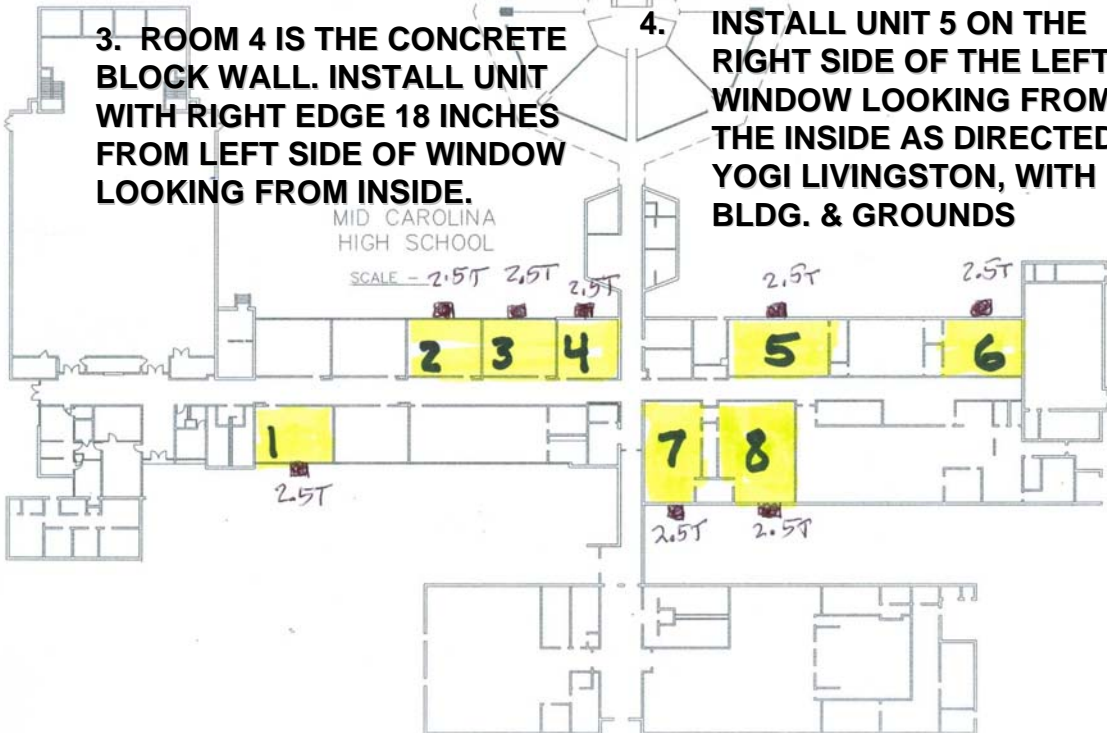
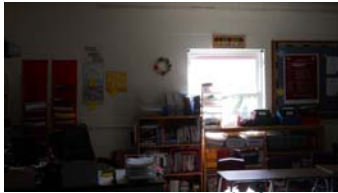

MOUNT ALL TSTATS 8 INCHES TO THE LEFT OF THE SUPPLY GRILLE



ELECTRICAL PANEL THREE LOCATION

ELECTRICAL PANEL TWO LOCATION

MAIN ELECTRICAL PANEL LOCATION

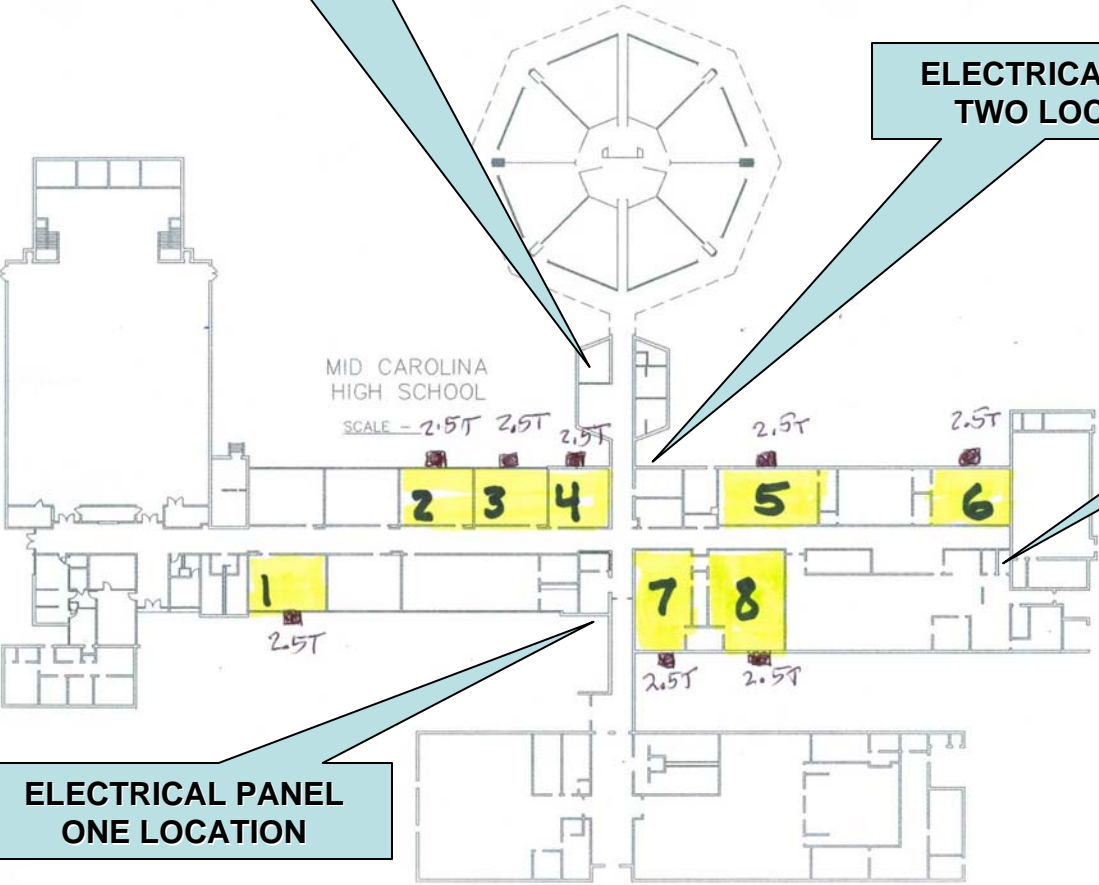

ELECTRICAL PANEL ONE LOCATION

ELECTRICAL SPECS:

- 1. EACH EXISTING UNIT IS 208 VOLTS AND SINGLE PHASE. THE NEW UNIT WILL REQUIRE A 50 AMP BREAKER. IF POSSIBLE, RE USE THE CONDUIT FROM THE BREAKER PANEL TO EXTERIOR OF EACH ROOM CLOSE TO WHERE THE HEAT PUMP IS TO BE INSTALLED.**
- 2. EACH EXISTING BREAKER IN THE PANEL MUST BE REPLACED WITH A NEW BREAKER.**
- 3. ALL CONDUIT WILL BE RUN IN CONDUIT AND NOT EMT. NO EXCEPTIONS.**
- 4. ALL ELECTRICAL WORK MUST MEET OR EXCEED REQUIREMENTS OF THE NATIONAL ELECTRICAL CODE AND MUST BE DONE BY A LICENSED ELECTRICAL CONTRACTOR.**

STIMULUS GRANT REQUIREMENTS:

- 1. BOTH THE MECHANICAL AND ELECTRICAL CONTRACTORS MUST MEET THE REQUIRMENTS FOR DAVIS BACON WAGE RATES AND THE WEEKLY REPORTS TO THE OWNER FOR DAVIS BACON WAGES. WAGE REQUIRMENTS ARE SHOWN WITHIN THIS DOCUMENT.**
- 2. BUY AMERICAN REQUIREMENTS: THE BUY AMERICAN REQUIREMENTS MEAN ALL MATERIALS PURCHASED IN TERMS OF WIRE, CONDUIT, FITTINGS, ETC MUST MEET BUY AMERICAN CLAUSE REQUIRMENTS.**

BILLING & COMPLETION DOCUMENTS:

- 1. ALL BILLS MUST BE SUBMITTED ON ORIGNAL AIA FORMS NOS. G702 AND CONTINUATION SHEET G-703. ALSO REQUIRED IN AIA FORMS ARE: G-704 (2000 VERSION) CERTIFICATE OF SUBSTANTIAL COMPLETION, G-706 (1974 VERSION) CONTRACTOR'S AFFADAVIT OF PAYMENT OF DEBTS AND CLAIMS AND G-706A (1994 VERSION) CONTRACTORS AFFADAVIT OF RELEASE OF LIENS.**

DAVIS BACON WAGE RATE FORMS:

- 1. ALL DAVIS BACON WAGE RATE FORMS MUST BE SUBMITTED ON AN APPROVED COPY OF THE WAGE RATE FORM ISSUED BY THE DEPARTMENT OF LABOR.**



**EXAMPLE OF WHAT WE WANT
WHEN MOUNTING THE BARD UNIT.
REFER QUESTIONS TO KENNETH
RAWLS WITH THE DISTRICT.**





INTERIOR VIEW OF THE CLASSROOM FOR UNIT NO. FOUR. CENTER UNIT BETWEEN WINDOW & DOOR.

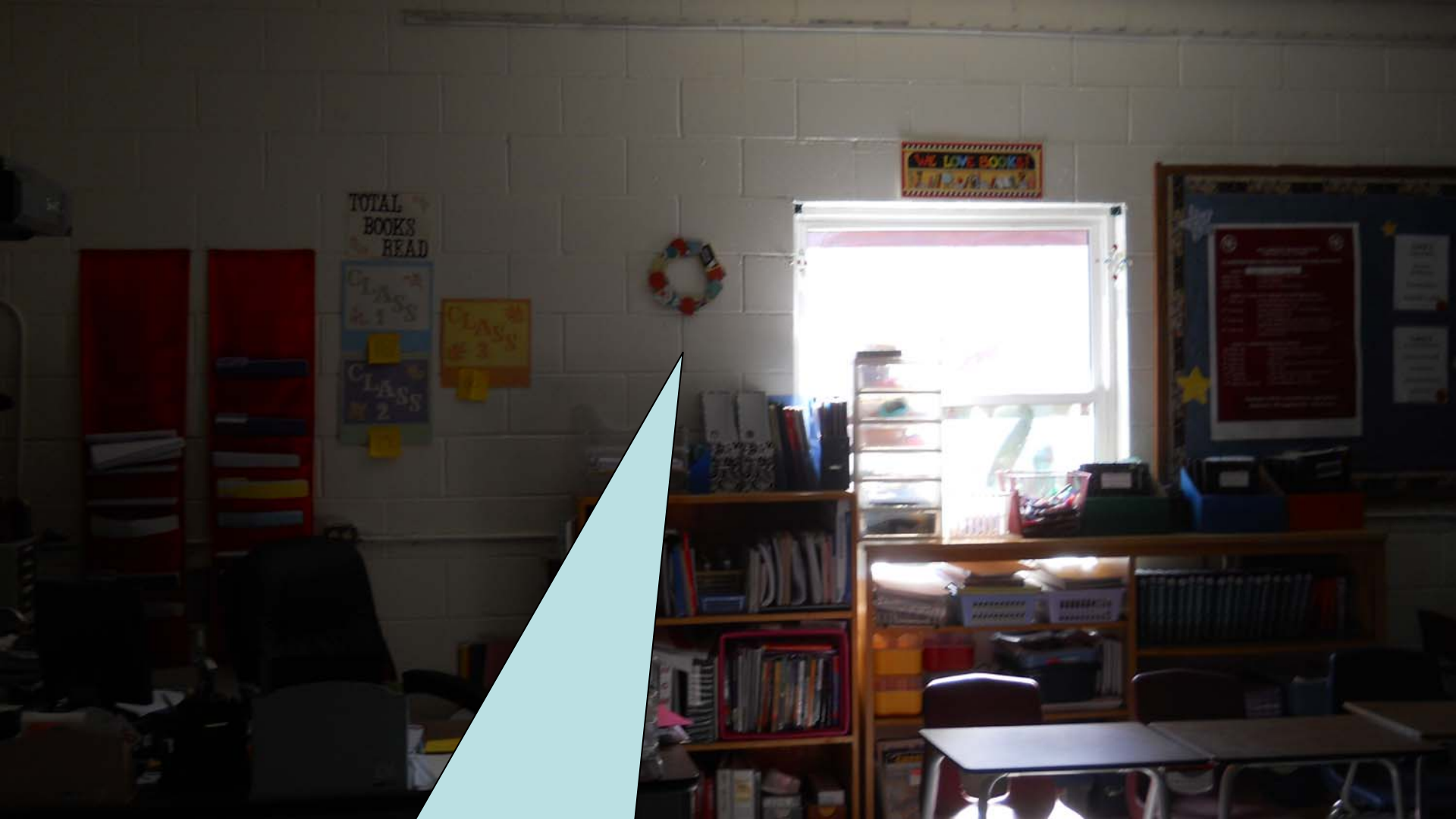

THE RIGHT EDGE OF THE UNIT IS TO BE LOCATED 18 INCHES FROM THE LEFT EDGE OF THE WINDOW SHOWN FOR UNIT NO. FOUR.



UNIT NO. ONE IS THE BE INSTALLED CENTERED IN BETWEEN THE TWO WINDOWS IN CLASSROOM NO. ONE AT THIS APPX. LOCATION.

Dimensions of Basic Unit for Architectural and Installation Requirements (Nominal)

MODEL	WIDTH (W)	DEPTH (D)	HEIGHT (H)	SUPPLY		RETURN																
				A	B	C	B	E	F	G	I	J	K	L	M	N	O	P	Q	R	S	T
WA18 WA24 WA25	33.300	17.125	70.563	7.88	19.88	11.88	19.88	35.00	18.50	25.75	20.56	26.75	28.06	29.25	27.00	2.63	34.13	22.06	10.55	4.75	12.00	5.00
WA30 WA36 WA37	38.200	17.125	70.563	7.88	27.88	13.88	27.88	40.00	18.50	25.75	17.93	26.75	28.75	29.25	27.00	2.75	39.19	22.75	9.14	4.75	12.00	5.00
WA42 WA48 WA60	42.075	22.432	84.875	9.88	29.88	15.88	29.88	43.88	19.10	31.66	30.00	32.68	26.94	34.69	32.43	3.37	42.88	23.88	10.00	2.00	16.00	1.88

All dimensions are in inches. Dimensional drawings are not to scale.

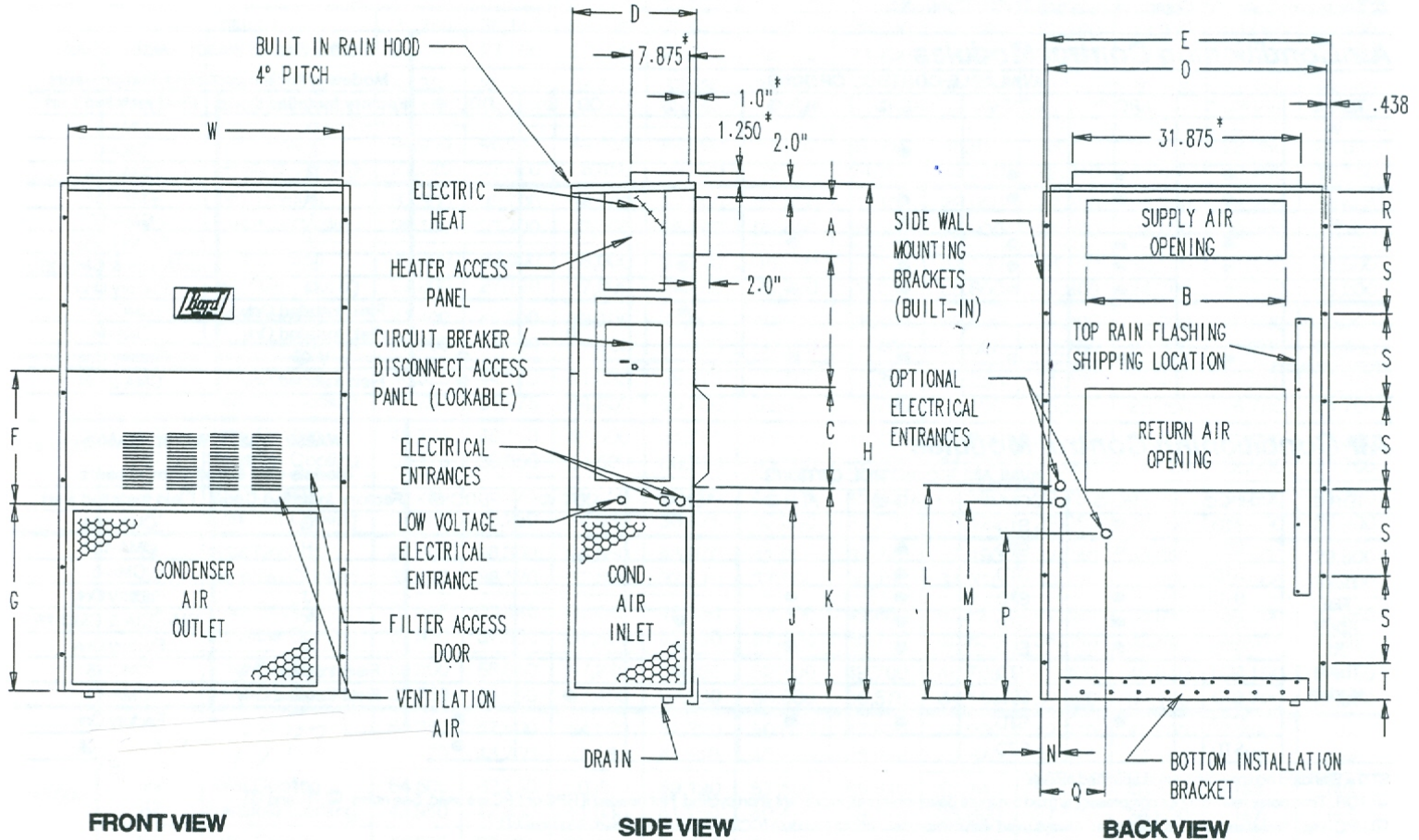

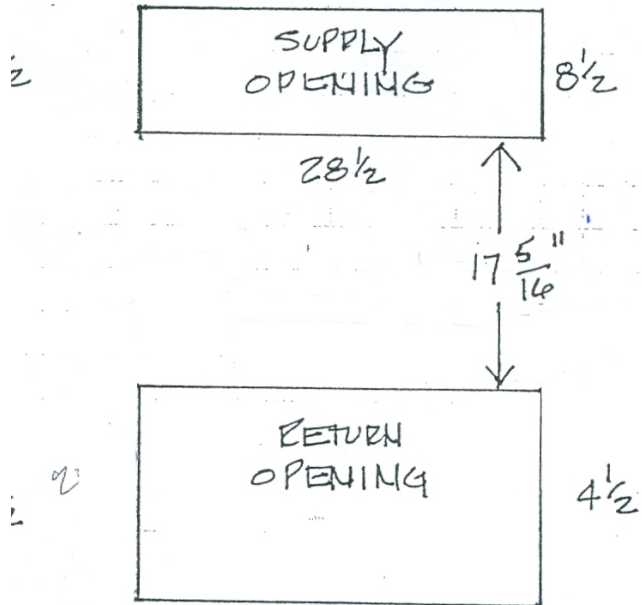

WH261 SH261 240
 WH311 SH311 25
 WH301
 WH361

BARD WALLMOUNT HEAT PUMP
 WALL OPENING SIZES
 1/4" ALLOWANCE ALL SIDES

SHEETMETAL FLASHING, SECURE TO UNIT AND WALL AND SEAL WATER-TIGHT

TYPICAL HEATPUMP

FRESH AIR DAMPER

UNIT SUPPORT, SECURE TO UNIT AND WALL (TYPICAL)

NOTE:
 SERVICE CLEARANCES ARE AS FOLLOWS:
 RIGHT SIDE - 30"
 LEFT SIDE - 15"

GRADE

LOCATION OF SUPPLY GRILLE BEING SUPPLIED WITH THE UNIT

LOCATION OF RETURN GRILLE BEING SUPPLIED WITH THE UNIT

HEATPUMP UNIT DETAIL
 NO SCALE

HVAC NOTES:

- BOTH SUPPLY AND RETURN GRILLES ARE BEING SUPPLIED OVERSIZED. ROUGH FOR APPROPRIATE SIZES.**
- INSTALL TSTAT (SUPPLIED WITH UNIT) ADJACENT TO RETURN GRILLE**
- TSTAT WIRING BY MECHANICAL CONTRACTOR.**
- ALL RETURN GRILLES MUST BE FILTER GRILLES.**



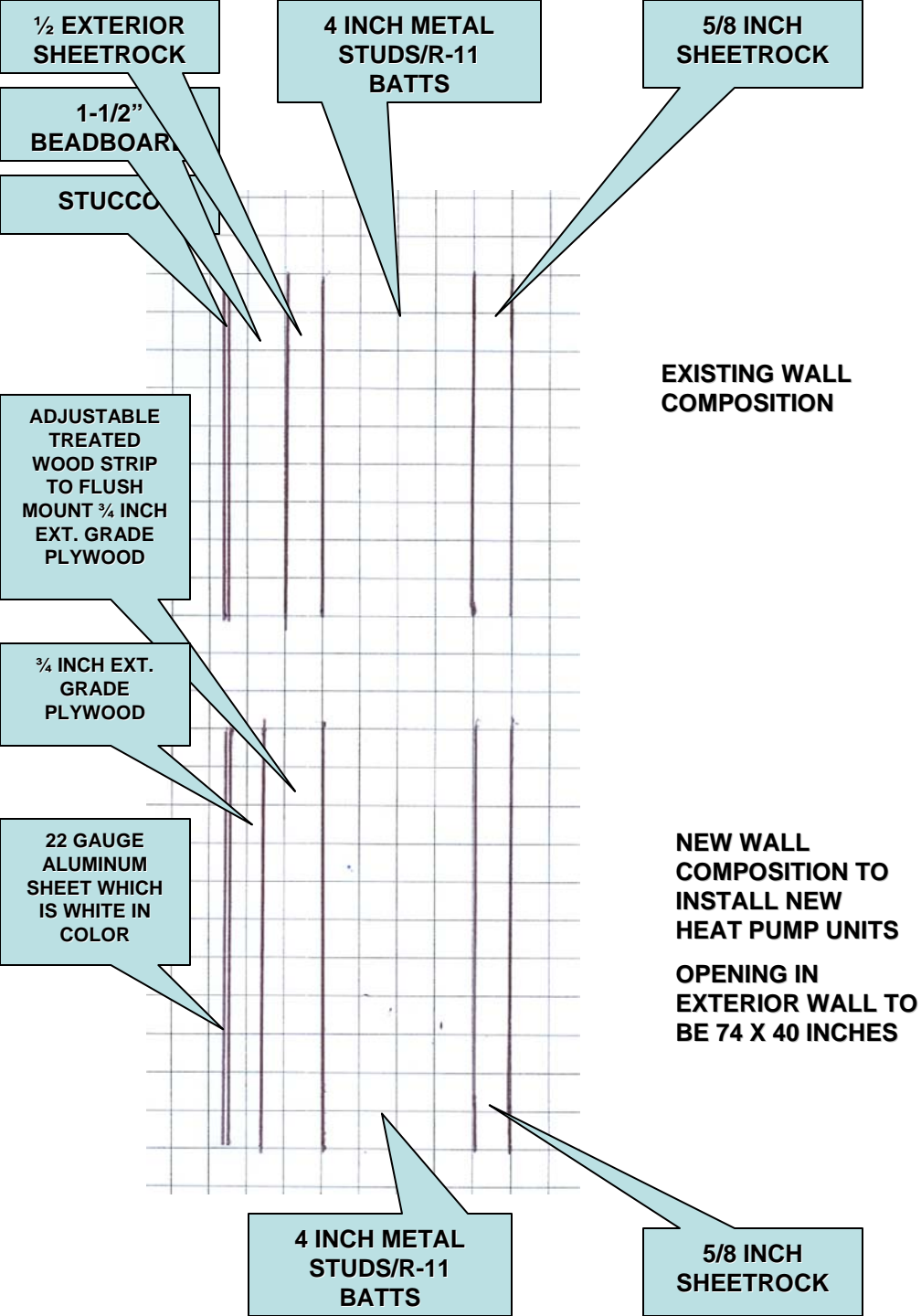

WALL CHANGES NEEDED TO INSTALL HEAT PUMPS:

CUT A HEAT PUMP OPENING ON THE OUTSIDE PART OF THE WALL WHICH IS 74 INCHES TALL AND 40 INCHES WIDE.

- 1. PROVIDE A HEADER ATTACHED TO WALL STUDS WITH 2 INCH ANGLE IRON CLIPS TO ANCHOR THE VERTICAL STUDS TO THE WALL.**
- 2. INSTALL VERTICAL 2 X 4 STUDS ON EITHER SIDE OF THE SUPPLY AND RETURN GRILLES.**
- 3. INSTALL HORIZONTAL 2 X 4 STUDS ON ALL SIDES OF THE SUPPLY AND RETURN OPENINGS.**
- 4. ANCHOR VERTICAL OPENINGS WITH 2 INCH ANGLE IRON CLIPS 3 INCHES WIDE AND ATTACH THEM TO BOTH THE TOP HEADER AND THE BOTTOM OF THE WALL SECURELY.**
- 5. FLUSH THE OUTSIDE EDGE OF THE 3/4 INCH EXTERIOR GRADE PLYWOOD TO BE MOUNTED FLUSH WITH THE OUTSIDE OF THE STUCCO EXTERIOR FINISH.**
- 6. BEFORE THE HEAT PUMP IS MOUNTED, COVER THE OPENING WITH 22 GA ALUMINUM WHITE IN COLOR AND OVERLAP THE STUCCO BY TWO INCHES ON ALL SIDES EXCEPT THE BOTTOM.**
- 7. CAULK THE METAL WITH WHITE EXTERIOR GRADE CAULK ON ALL THREE SIDES AND THE BOTTOM.**

THERE IS ONE UNIT BEING MOUNTED ON A CONCRETE BLOCK WALL.

MOUNT A PIECE OF 3/4 INCH EXTERIOR GRADE PLYWOOD ON THE EXTERIOR OF THE BUILDING AND ON THE INTERIOR OF THE WALL WHERE THE GRILLES WILL BE MOUNTED. COVER BOTH SIDES WITH 22 GA WHITE ALUMINUM BEFORE EITHER THE UNIT OR THE GRILLES ARE INSTALLED.

DAVIS BACON WAGE RATES REQUIRED FOR NEWBERRY COUNTY SCHOOLS WORK

http://www.wdol.gov/wdol/scafiles/davisbacon/SC1.dvb

http://www.wdol.gov/wdol/scafiles/davisbacon/SC1.dvb

General Decision Number: SC100001 03/12/2010 SC1

Superseded General Decision Number: SC20080001

State: South Carolina

Construction Type: Building

Counties: Abbeville, Chester, Fairfield, Greenwood, Laurens, McCormick, Newberry, Oconee, Saluda and Union Counties in South Carolina.

BUILDING CONSTRUCTION PROJECTS (does not include single family homes and apartments up to and including 4 stories)

Modification Number 0 Publication Date 03/12/2010

* SUSC1995-001 07/03/1995

	Rates	Fringes
Bricklayer.....	\$ 12.29	
Carpenter _ (includes batt insulation and drywall hanging)...	\$ 10.20	
Cement mason/concrete finisher.....	\$ 10.50	
Electrician.....	\$ 10.97	
Glazier _ Duct work.....	\$ 10.17	1.15
Ironworker, structural.....	\$ 9.00	
Laborers: _ General.....	\$ 7.25	
_ Mason tender.....	\$ 7.25	1.37
Painter _ (includes drywall finishing).....	\$ 8.80	
Plumber _ (does not include HVAC piping).....	\$ 11.48	
Power equipment operators: _ Backhoe.....	\$ 9.81	
_ Grader/gradall.....	\$ 10.93	
Roofer.....	\$ 8.56	
Sheet metal worker _ (does not include HVAC duct work).....	\$ 10.00	

Tile setter.....	\$ 10.00	
Truck driver.....	\$ 7.25	
Heating, Ventilation & Air Condition Mechanic		
_ Duct work.....	\$ 9.86	.71
_ Piping.....	\$ 9.63	.81

WELDERS - Receive rate prescribed for craft performing operation to which welding is incidental.

Unlisted classifications needed for work not included within the scope of the classifications listed may be added after award, only as provided in the labor standards contract clauses (29CFR 5.5 (a) (1) (ii)).

In the listing above, the "SU" designation means that rates listed under the identifier do not reflect collectively bargained wage and fringe benefit rates. Other designations indicate unions whose rates have been determined to be prevailing.

WAGE DETERMINATION APPEALS PROCESS

1.) Has there been an initial decision in the matter? This can be:

- * an existing published wage determination
- * a survey underlying a wage determination
- * a Wage and Hour Division letter setting forth a position on a wage determination matter
- * a conformance (additional classification and rate) ruling

On survey related matters, initial contact, including requests for summaries of surveys, should be with the Wage and Hour Regional Office for the area in which the survey was conducted because those Regional Offices have responsibility for the Davis-Bacon survey program. If the response from this initial contact is not satisfactory, then the process described in 2.) and 3.) should be followed.

With regard to any other matter not yet ripe for the formal process described here, initial contact should be with the Branch of Construction Wage Determinations. Write to:

Branch of Construction Wage Determinations
Wage and Hour Division
U.S. Department of Labor
200 Constitution Avenue, N.W.
Washington, DC 20210

2.) If the answer to the question in 1.) is yes, then an interested party (those affected by the action) can request review and reconsideration from the Wage and Hour Administrator (See 29 CFR Part 1.8 and 29 CFR Part 7). Write to:

Wage and Hour Administrator
U.S. Department of Labor
200 Constitution Avenue, N.W.
Washington, DC 20210

The request should be accompanied by a full statement of the interested party's position and by any information (wage payment data, project description, area practice material, etc.) that the requestor considers relevant to the issue.

3.) If the decision of the Administrator is not favorable, an interested party may appeal directly to the Administrative Review Board (formerly the Wage Appeals Board). Write to:

Administrative Review Board
U.S. Department of Labor
200 Constitution Avenue, N.W.
Washington, DC 20210

4.) All decisions by the Administrative Review Board are final.

END OF GENERAL DECISION

THE CERTIFICATIONS/WARRANTY ITEMS ON THE NEXT TWO PAGES MUST BE COMPLETED BY THE CONTRACTOR AND SUBMITTED AT SUBSTANTIAL COMPLETION AND INCLUDE A. CONTRACTORS ONE YEAR GUARANTEE, B. CERTIFICATION OF BUY AMERICAN COMPLIANCE AND C. CERTIFICATION OF DAVIS BACON WAGE RATE COMPLIANCE

NEWBERRY COUNTY SCHOOLS
ARRA Stimulus HVAC Retrofit Project

CONTRACTORS GENERAL GUARANTEE

STATE OF SOUTH CAROLINA
COUNTY OF NEWBERRY
PROJECT: ARRA STIMULUS HVAC PROJECT

This is to certify that the undersigned, as Mechanical Contractor for the above named project, hereby guarantees that all work executed under the requirements of the Contract Documents shall be free from defects in materials and/or workmanship for a period of one (1) year from the Date of Substantial Completion, as established by the properly executed Certificate of Substantial Completion, and agrees to remedy defects due to faulty materials and/or workmanship and to repair any damage resulting there from, at no expense to the Owner, provided, however, that the following are excluded from this guarantee:

- a. Defects in material or workmanship in work performed by others under separate contracts, unless such defects are the result of improper coordination, defective preparatory work, or failure to meet other requirements of the General Contract.
- b. Defects or failures resulting from abuse by Owner or occupants of the building.
- c. Damage caused by lightening, tornado, hurricane, hail, fire, other unusual phenomena of the elements or acts of God.

The undersigned further agrees that positive action to correct any defects will be undertaken within ten (10) days from the date of notification by the Owner, and that failure to take such action shall serve as authorization by the undersigned for the Owner to effect the necessary corrections and repairs, and the undersigned will be held responsible for reimbursing the Owner for all reasonable costs incurred there from.

Mechanical Contractor

By _____
Title _____

SWORN TO before me this _____ day
of _____, 20____.

Notary Public

Corporate Seal:

NEWBERRY COUNTY SCHOOLS
ARRA Stimulus HVAC Retrofit Project

BUY AMERICAN ACT-CONSTRUCTION MATERIALS

CERTIFICATION OF BUY AMERICAN ACT COMPLIANCE

1.01 DATE: _____ (Contractor to enter date)

1.02 FOR: Certification of Buy American Act Compliance

1.03 SUBMITTED BY: (Contractor to enter name and address)

- A. Contractor's Full Name _____
- 1. Address _____
- 2. City, State, Zip _____

1.04 CERTIFICATION:

- A. We, _____, Certify that we and our sub-contractors will comply with the Buy American Act ([41 U.S.C. 10a - 10g](#)) for the Newberry County Schools ARRA Stimulus HVAC Retrofit Project located in NEWBERRY County, South Carolina and that any additional cost required to provide construction materials made in American have been incorporated into the construction contract for the NEWBERRY County SchoolS ARRA Stimulus HVAC Retrofit Project in compliance with the Buy American Act.

Sworn to and subscribed before me this _____ day of _____, 2010.

1.05 CONTRACTOR'S SIGNATURE(S)

- A. By: _____
- B. _____
- C. Title: _____
- D. _____
- E. Date: _____
- F. _____
- G. Notary Public: _____ (Seal)
- H. _____

CERTIFICATION OF WAGE RATE COMPLIANCE

1.01 DATE: _____ (Contractor to enter date)

1.02 FOR: Certification of Wage Rate Compliance

1.03 SUBMITTED BY: (Contractor to enter name and address)

- A. Contractor's Full Name _____
1. Address _____
2. City, State, Zip _____

1.04 CERTIFICATION:

- A. We, _____, Certify that we and our sub-contractors have obtained the latest prevailing wage rates from the U.S. Department of Labor for the Florence County School District #2 ARRA Stimulus HVAC Retrofit Project located in NEWBERRY County, South Carolina and that these rates have been incorporated into the construction contract for the NEWBERRY County Schools ARRA Stimulus HVAC Retrofit Project in compliance with the Davis-Bacon Act.

Sworn to and subscribed before me this _____ day of _____, 2010.

1.05 CONTRACTOR'S SIGNATURE(S)

- A. By: _____
B. _____
C. Title: _____
D. _____
E. Date: _____
F. _____
G. Notary Public: _____ (Seal)
H. _____